

AUTOMATIC SPEED GOVERNOR

3.9.0.037.XX.00



The automatic speed governor adjusts the engine speed automatically as the hydraulic system comes under load, i.e. when the crane begins working, it then reduces back to normal idling r.p.m. when the crane is not operating. This considerably reducing noise, pollution and fuel consumption whilst providing a reliable method of powering cranes and other hydraulically operated equipments.

MOUNTING INSTRUCTIONS

Connect the automatic speed governor pressure side (ref. 1) of the hydraulic pump by means at a high pressure hose. Fasten the automatic speed governor (ref. 2) and join the graduated lever (ref. 3) by a steel cable (ref. 4) to the injection pump of the engine (ref. 5). The steel cable (ref. 4) is to be fitted to 1 of 3 existing holes on the graduated lever of the automatic speed governor (ref. 2).

Pressure max.: 350 bar

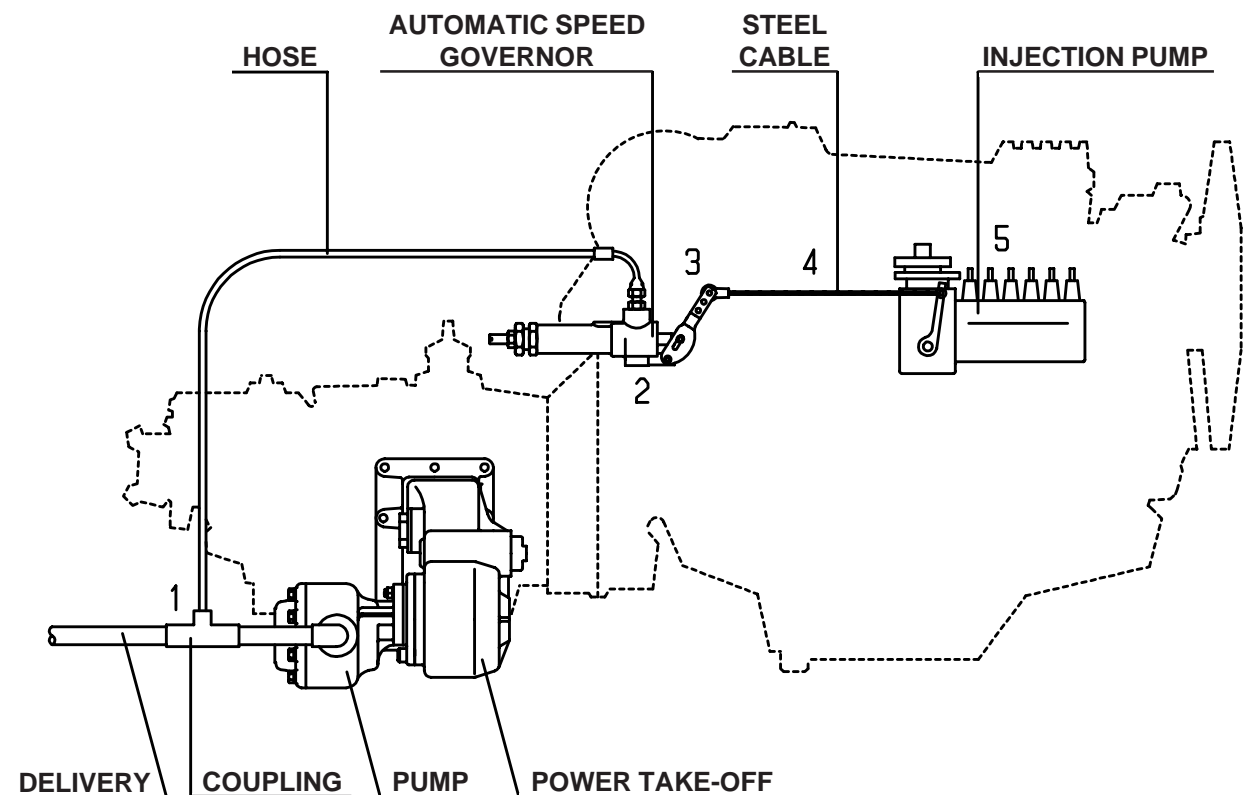

3.9.0.037.XX.00

BASIC SERIAL NUMBER

VERSION

- 01** = SETTING FROM 0 TO 80 BAR
- 02** = SETTING FROM 80 TO 150 BAR

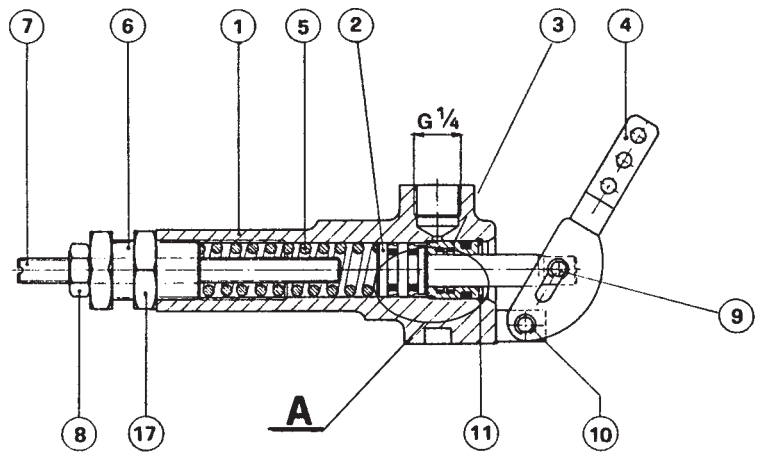
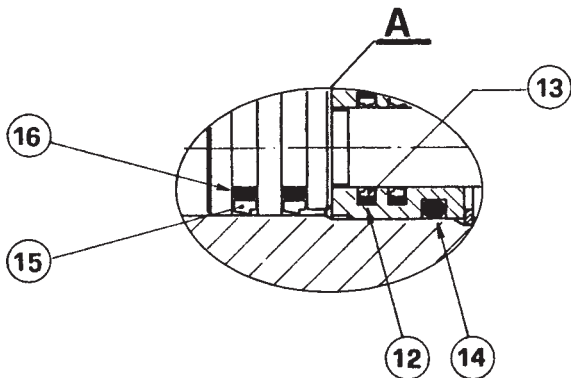
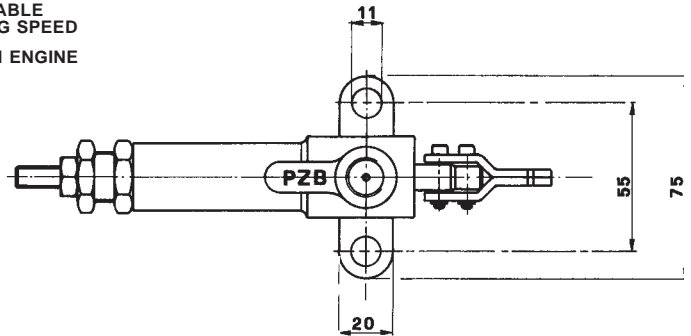
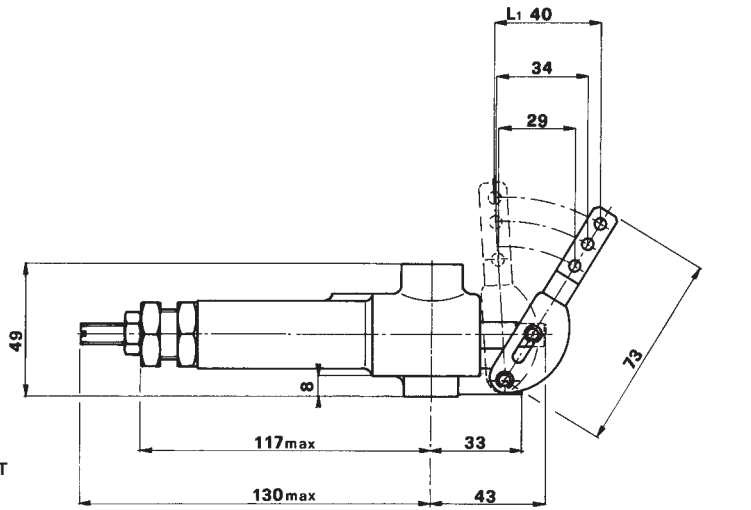
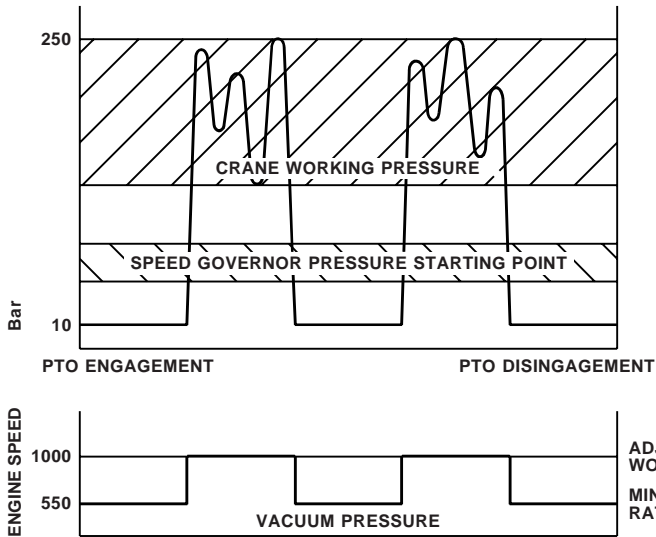

REF.	CODE	DESCRIPTION	QT.
1	1.08.01.007.00	Body	1
2	1.21.01.022.00	Piston	1
3	1.24.99.008.00	Bushing	1
4	1.23.00.035.00	Graduated lever	1
5	1.28.01.043.00	Spring (3.9.0.037.02.00)	1
	1.28.01.047.00	Spring (3.9.0.037.01.00)	
6	1.30.01.041.00	Adjusting screw	1
7	1.30.01.042.00	Grub screw	1
8	0.03.01.010.00	Hex nut M8 UNI 5588 CL RES 8	1
9	1.14.02.036.00	Pin	2
10	0.99.00.139.00	Retraining radial ring 2,3 Anderton	2
11	0.07.02.033.00	Circlip 18i UNI 7437	1
12	0.08.02.037.00	O-Ring OR 2043	2
13	0.99.00.140.00	Backup seal S-55015-0100-451	2
14	0.08.02.066.00	O-Ring OR 117	1
15	0.99.00.141.00	Backup seal S-55014-0170-451-K	2
16	0.08.02.077.00	O-Ring OR 3037	2
17	1.30.02.018.00	Hex nut M18x1,5x7	1